

NOTIFY DISTRICT OFFICE 24 HOURS PRIOR TO CEMENTING SURFACE CASING.

25.2. PIT INFORMATION:

A. TYPE OF MUD SYSTEM: ☐ WATER BASED ☐ OIL BASED ☐ GAS BASED (AIR DRILL)
 B. EXPECTED MUD CHLORIDE CONTENT: maximum: _____ ppm; average: _____ ppm.
 C. TYPE OF PIT SYSTEM: ☐ on-site ☐ off-site ☐ closed If off-site, specify location: _____
 D. IS DEPTH TO TOP OF GROUND WATER GREATER THAN 10 FT BELOW BASE OF PIT? ☐ Y ☐ N
 E. WITHIN 1 MILE OF MUNICIPAL WATER WELL? ☐ Y ☐ N Off-Site Pit No. _____
 F. WELLHEAD PROTECTION AREA? ☐ Y ☐ N

26.2 OCC USE ONLY		A. CATEGORY		1A	1B	2	3	4	C	Fm:	Other H.S.A.	Non-H.S.A.
B. PIT LOCATION:		Alluvial Plain		Terrace Deposit		Bedrock Aquifer						
C. Special area or field rule?				D. DEEP SCA?		Y		N		E. CBL?		Y
F. SOIL COMPACTED LINER REQUIRED?		Y		N		G. 20 mil GEOMEMBRANE LINER REQUIRED		Y		N		
29 Bottom Hole Location for Directional Hole:		SEC	TWP	RGE	COUNTY							
SPOT LOCATION:		1/4	1/4	1/4	1/4	FEET FROM QUARTER SECTION LINES:		from SOUTH LINE		from WEST LINE		
Measured Total Depth		True Vertical Depth		BHL from nearest Lease, Unit, Or Property Line:								
30. Bottom Hole Location for Horizontal Hole: (LATERALS)												
LATERAL #1:		SEC	TWP	RGE	COUNTY							
SPOT LOCATION:		1/4	1/4	1/4	1/4	FEET FROM QUARTER SECTION LINES:		from SOUTH LINE		from WEST LINE		
Depth of Deviation		Radius of Turn		Direction		Total Length						
Measured Total Depth		True Vertical Depth		End Point location from nearest lease, unit or property line:								
LATERAL #2:												
SPOT LOCATION:		1/4	1/4	1/4	1/4	FEET FROM QUARTER SECTION LINES:		from SOUTH LINE		from WEST LINE		
Depth of Deviation		Radius of Turn		Direction		Total Length						
Measured Total Depth		True Vertical Depth		End Point location from nearest lease, unit or property line:								
LATERAL #3:												
SPOT LOCATION:		1/4	1/4	1/4	1/4	FEET FROM QUARTER SECTION LINES:		from SOUTH LINE		from WEST LINE		
Depth of Deviation		Radius of Turn		Direction		Total Length						
Measured Total Depth		True Vertical Depth		End Point location from nearest lease, unit or property line:								

28. Locate Bottom Hole

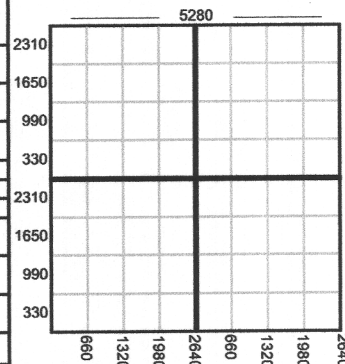

1. If more than two drainholes are proposed, attach separate sheet indicating the necessary information.
2. Direction must be stated in degrees azimuth.
3. Please note the horizontal drainhole and its end point must be located within the legal boundaries of the lease or spacing unit. Directional surveys are required for all drainholes and directional wells.

31. AFFIDAVIT FOR ALTERNATIVE CASING PROGRAM

(Signature on front of this form attests to this affidavit)

1. This well ☐ WILL ☐ WILL NOT penetrate any known lost circulation zones.
2. During the drilling of this well, withdrawals from any water well within 1/4 mile ☐ WILL ☐ WILL NOT exceed 50 gallons per minute.
3. The projected depth of the well ☐ IS ☐ IS NOT less than 100 feet from the top of any enhanced recovery project or gas storage facility.
4. List the following for all water wells within 1/4 mile of this well. (Information concerning some water wells may be obtained from the OKLAHOMA WATER RESOURCES BOARD, 3800 N. Classen Blvd., Oklahoma City, OK 73118). IF NO WATER WELLS FOUND, SO STATE. (ATTACH ADDITIONAL SHEET IF NECESSARY)

Name of Owner/Operator	Address of Owner/Operator	Location (Nearest 1/4 1/4 1/4 1/4)	Depth of Well

5. A cement bond log is required to be run and submitted from not less than 100 feet below the base of the treatable water-bearing formation to the surface. **OCC USE ONLY**
6. If casing depth is more than 250 feet deeper than base of the treatable water-bearing formation, operator must submit a letter of request listing reasons and precautions to be taken.

INTENT TO DRILL CHECKLIST

APPROVED ☒ REJECTED ☐

1. SURETY
 - A. NONE filed. 4/29/19
 - B. EXPIRED: Date _____
 - C. OUTSTANDING CONTEMPT ORDER.

4. GEOLOGY

DO NOT WRITE INSIDE THIS BOX

OCC USE ONLY

OKLA CORP COMM
 RECEIPT 181160017
 Date: 05/02/2018 Time: 12:01
 Case: 00000000 Cashier: CRS
 Payor: RAYLAND OPERATING
 Check: 10194 \$500.00
 45 Emergency Walk Thru ITD

PRIMARY WELL SITE EXHIBIT

WELL SITE

LYING IN THE NORTHWEST QUARTER
OF THE NORTHEAST QUARTER
OF SECTION 8-T7N-R8E
OF THE INDIAN MERIDIAN,
HUGHES COUNTY, OKLAHOMA

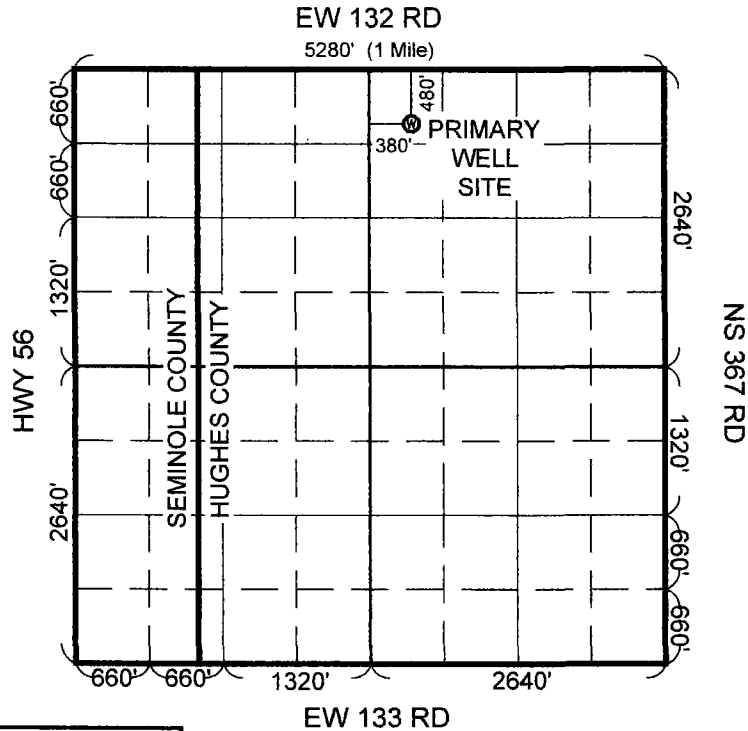

5' 40"
28' 40"
480'
2160'

LINE AND SYMBOL LEGEND

(W) PROPOSED WELL LOCATION

(1 Inch = 1320 Feet)

WELL DATA

WELL DESC.	DISTANCE FNL	DISTANCE FWL	LAT. (DMS)	LONG (DMS)	LAT. (DEC.)	LONG. (DEC.)	GROUND ELEV.
PRIMARY	480' FNL	380' FWL	35° 06' 00.16" N	96° 29' 03.19" W	35.10004	-96.48422	944.3'

NOTES

- 1.) This Well Survey Exhibit was prepared for Rayland Operating and authorized by Doug Worley on March 21, 2018.
- 2.) While the locations as shown hereon were carefully staked and/or located according to official survey records, plats or other maps, it is not a land or boundary survey plat. Any linear and angular values shown on the sketch, if any, are based on record or deed information and have not been verified unless noted.
- 3.) Vertical Datum: NAVD 1929



FORESIGHT LAND SURVEYING, LLC

1109 WARREN ROAD
HENRYETTA, OK 74437
918-268-2502
OFFICE@FORESIGHTSURVEYING.NET
WWW.FORESIGHTSURVEYING.NET
CA #7652

SHEET: 1 OF 1
Date: 04/12/2018
Drawn by: JRL
Fieldwork by: JDK
For: D. Worley
Rayland Operating
Project No. 18-0131