

OKLAHOMA CORPORATION COMMISSION  
OIL & GAS CONSERVATION DIVISION  
P.O. BOX 52000  
OKLAHOMA CITY, OK 73152-2000  
(Rule 165:10-3-1)

API NUMBER: 073 25917

Approval Date: 02/05/2018

Expiration Date: 08/05/2018

Straight Hole

Disposal

PERMIT TO DRILL

WELL LOCATION: Sec: 29 Twp: 16N Rge: 9W

County: KINGFISHER

SPOT LOCATION:

FEET FROM QUARTER: FROM NORTH FROM EAST

SECTION LINES: 2505 2510

Lease Name: SALT LICK SWD

Well No: 2

Well will be 130 feet from nearest unit or lease boundary.

Operator Name: S & S STAR OPERATING LLC

Telephone: 3033046523

OTC/OCC Number: 23996 0

S & S STAR OPERATING LLC  
1308 LAKE ST  
FORT WORTH, TX 76102-4505

RANDY & JANE LONGDAGIN  
10516 NORTH 2010 ROAD  
ELK CITY OK 73644

Formation(s) (Permit Valid for Listed Formations Only):

	Name	Depth	Name	Depth
1	WOLFCAMPIAN	3750	6	
2	VIRGILIAN	4000	7	
3			8	
4			9	
5			10	

Spacing Orders: No Spacing

Location Exception Orders:

Increased Density Orders:

Pending CD Numbers:

Special Orders:

Total Depth: 6000

Ground Elevation: 1184

**Surface Casing: 775**

Depth to base of Treatable Water-Bearing FM: 650

Under Federal Jurisdiction: No

Fresh Water Supply Well Drilled: No

Surface Water used to Drill: No

PIT 1 INFORMATION

Approved Method for disposal of Drilling Fluids:

Type of Pit System: ON SITE

A. Evaporation/dewater and backfilling of reserve pit.

Type of Mud System: WATER BASED

Chlorides Max: 5000 Average: 3000

Is depth to top of ground water greater than 10ft below base of pit? Y

Within 1 mile of municipal water well? N

Wellhead Protection Area? N

Pit is not located in a Hydrologically Sensitive Area.

Category of Pit: 2

Liner not required for Category: 2

Pit Location is NON HSA

Pit Location Formation: CHICKASHA

Notes:

This permit does not address the right of entry or settlement of surface damages.  
The duration of this permit is SIX MONTHS, except as otherwise provided by Rule 165: 10-3-1.  
Rule 165: 10-3-4 (c) (7) (e) - The Operator shall give 24 Hours notice by telephone to the appropriate District Office of the Conservation Division as to when Surface Casing will be run.

Category	Description
HYDRAULIC FRACTURING	<p>1/30/2018 - G71 - OCC 165:10-3-10 REQUIRES:</p> <p>1) PRIOR TO COMMENCEMENT OF HYDRAULIC FRACTURING OPERATIONS FOR HORIZONTAL WELLS, NOTICE GIVEN FIVE BUSINESS DAYS IN ADVANCE TO OFFSET OPERATORS WITH WELLS COMPLETED IN THE SAME COMMON SOURCE OF SUPPLY WITHIN 1/2 MILE;</p> <p>2) WITH NOTICE ALSO GIVEN 48 HOURS IN ADVANCE OF HYDRAULIC FRACTURING ALL WELLS TO BOTH THE OCC CENTRAL OFFICE AND LOCAL DISTRICT OFFICES, USING THE "FRAC NOTICE FORM" FOUND AT THE FOLLOWING LINK: <a href="http://OCCWEB.COM/OG/OGFORMS.HTML">OCCWEB.COM/OG/OGFORMS.HTML</a>; AND,</p> <p>3) THE CHEMICAL DISCLOSURE OF HYDRAULIC FRACTURING INGREDIENTS FOR ALL WELLS TO BE REPORTED TO FRACFOCUS WITHIN 60 DAYS AFTER THE CONCLUSION THE HYDRAULIC FRACTURING OPERATIONS, USING THE FOLLOWING LINK: <a href="http://FRACFOCUS.ORG">FRACFOCUS.ORG</a></p>
SPACING	1/30/2018 - G71 - N/A - DISPOSAL WELL
SURFACE LOCATION	2/5/2018 - G75 - 2505' FNL, 2510' FEL NE4 29-16N-9W PER STAKING PLAT

# TOPOGRAPHIC LAND SURVEYORS OF OKLAHOMA

13800 WIRELESS WAY, OKLA. CITY, OKLA. 73134 \* LOCAL (405) 843-4847 \* OUT OF STATE (800) 654-3219

Certificate of Authorization No. 1293 LS

API 073-25917

KINGFISHER

County, Oklahoma

2505' FNL-2510' FEL Section 29 Township 16N Range 9W I.M.

X= 1949188  
Y= 306216

X= 1946556  
Y= 306211

X= 1949204  
Y= 303577

**NOTE:**  
The information shown herein is for  
construction purposes ONLY.



GRID  
NAD-27  
OK NORTH  
US Feet

0' 500' 1000'

Distances shown in (parenthesis) are calculated based upon the Quarter Section being 2640 feet, those shown in [brackets] are based on GLO (General Land Office) distances and have NOT been measured on the ground.

Operator: S&S STAR OPERATING LLC

Lease Name: SALT LICK SWD

Well No.: #2

**ELEVATION:**

1184' Gr. at Stake

Topography & Vegetation Loc. fell in level wheat field

Good Drill Site? Yes Reference Stakes or Alternate Location  
Stakes Set None

Best Accessibility to Location From East off county road.

Distance & Direction  
from Hwy Jct or Town From the Junction of St. Hwy. 33 E-W and Omega Rd. N-S, go East

±1 mile on St. Hwy. 33 to the NE Cor. of Sec. 29-T16N-R9W.

DATUM: NAD-27

LAT: 35°50'03.1"N

LONG: 98°10'47.4"W

LAT: 35.834202471°N

LONG: 98.179833551°W

STATE PLANE

COORDINATES: (US Feet)

ZONE: OK NORTH

X: 1946693

Y: 303706

Invoice # 287054 Date of Drawing: Jan. 18, 2018

Date Staked: Jan. 17, 2018

TR

## CERTIFICATE:

I, Thomas L. Howell, an Oklahoma Licensed Land Surveyor and an authorized agent of Topographic Land Surveyors of Oklahoma, do hereby certify to the information shown herein

Oklahoma Lic. No. 1433

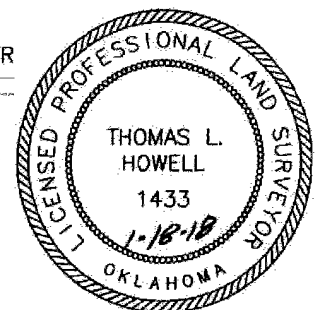

This information was gathered with a GPS receiver with ±1 foot Horiz./Vert. accuracy