

OKLAHOMA CORPORATION COMMISSION
OIL & GAS CONSERVATION DIVISION
P.O. BOX 52000
OKLAHOMA CITY, OK 73152-2000
(Rule 165:10-3-1)

API NUMBER: 063 24797

Approval Date: 05/02/2018

Expiration Date: 11/02/2018

Straight Hole

Oil & Gas

PERMIT TO DRILL

WELL LOCATION: Sec: 08 Twp: 7N Rge: 8E

County: HUGHES

SPOT LOCATION: ☐ SE ☐ NW ☐ NW ☐ NE

FEET FROM QUARTER: FROM NORTH FROM WEST

SECTION LINES: 480 380

Lease Name: LOOKENBACK

Well No: 8-1

Well will be 380 feet from nearest unit or lease boundary.

Operator Name: RAYLAND OPERATING LLC

Telephone: 6183342567

OTC/OCC Number: 23674 0

RAYLAND OPERATING LLC

PO BOX 93

MORO, IL 62067-0093

WILLIAM HASKINS & BERNICE HASKINS

6655 EW 1320 ROAD

WEWOKA OK 74884

Formation(s) (Permit Valid for Listed Formations Only):

	Name	Depth		Name	Depth
1	CALVIN	1430	6	CROMWELL	3330
2	SENORA	1880	7	HUNTON	4070
3	EARLSBORO	2550	8	VIOLA	4150
4	BOOCH	2950	9	1ST WILCOX	4230
5	UNION VALLEY	3250	10	2ND WILCOX	4300

Spacing Orders: 266814

Location Exception Orders:

Increased Density Orders:

Pending CD Numbers: 201708615

Special Orders:

Total Depth: 4400

Ground Elevation: 944

Surface Casing: 330

Depth to base of Treatable Water-Bearing FM: 280

Under Federal Jurisdiction: No

Fresh Water Supply Well Drilled: No

Surface Water used to Drill: Yes

PIT 1 INFORMATION

Approved Method for disposal of Drilling Fluids:

Type of Pit System: CLOSED Closed System Means Steel Pits

Type of Mud System: WATER BASED

Chlorides Max: 8000 Average: 5000

Is depth to top of ground water greater than 10ft below base of pit? Y

Within 1 mile of municipal water well? N

Wellhead Protection Area? N

Pit is located in a Hydrologically Sensitive Area.

Category of Pit: C

Liner not required for Category: C

Pit Location is BED AQUIFER

Pit Location Formation: SEMINOLE

D. One time land application -- (REQUIRES PERMIT)

PERMIT NO: 18-34432

H. CLOSED SYSTEM=STEEL PITS PER OPERATOR REQUEST

Notes:

This permit does not address the right of entry or settlement of surface damages.

063 24797 LOOKENBACK 8-1

The duration of this permit is SIX MONTHS, except as otherwise provided by Rule 165: 10-3-1.

Rule 165: 10-3-4 (c) (7) (e) - The Operator shall give 24 Hours notice by telephone to the appropriate District Office of the Conservation Division as to when Surface Casing will be run.

Category	Description
HYDRAULIC FRACTURING	<p>5/2/2018 - G71 - OCC 165:10-3-10 REQUIRES:</p> <p>1) PRIOR TO COMMENCEMENT OF HYDRAULIC FRACTURING OPERATIONS FOR HORIZONTAL WELLS, NOTICE GIVEN FIVE BUSINESS DAYS IN ADVANCE TO OFFSET OPERATORS WITH WELLS COMPLETED IN THE SAME COMMON SOURCE OF SUPPLY WITHIN 1/2 MILE;</p> <p>2) WITH NOTICE ALSO GIVEN 48 HOURS IN ADVANCE OF HYDRAULIC FRACTURING ALL WELLS TO BOTH THE OCC CENTRAL OFFICE AND LOCAL DISTRICT OFFICES, USING THE "FRAC NOTICE FORM" FOUND AT THE FOLLOWING LINK: OCCEWEB.COM/OG/OGFORMS.HTML; AND,</p> <p>3) THE CHEMICAL DISCLOSURE OF HYDRAULIC FRACTURING INGREDIENTS FOR ALL WELLS TO BE REPORTED TO FRACFOCUS WITHIN 60 DAYS AFTER THE CONCLUSION THE HYDRAULIC FRACTURING OPERATIONS, USING THE FOLLOWING LINK: FRACFOCUS.ORG</p>
PENDING CD - 201708615	<p>5/2/2018 - G75 - (40) NW4 NE4 8-7N-8E EXT 327573 WLCX1, WLCX2 EST UNVL, VIOL, OTHERS REC 1-22-2018 (MURER)</p>
SPACING - 266814	<p>5/2/2018 - G75 - (40) NE4 8-7N-8E EXT 137091 CLVN, SNOR, ERLB, BOCH, CMWL, OTHERS EXT OTHER EXT 139422 HNTN</p>
SURFACE LOCATION	<p>5/2/2018 - G75 - 480' FNL, 380' FWL NE4 8-7N-8E PER STAKING PLAT</p>

PRIMARY WELL SITE EXHIBIT API 063-24797

WELL SITE
 LYING IN THE NORTHWEST QUARTER
 OF THE NORTHEAST QUARTER
 OF SECTION 8-T7N-R8E
 OF THE INDIAN MERIDIAN,
 HUGHES COUNTY, OKLAHOMA

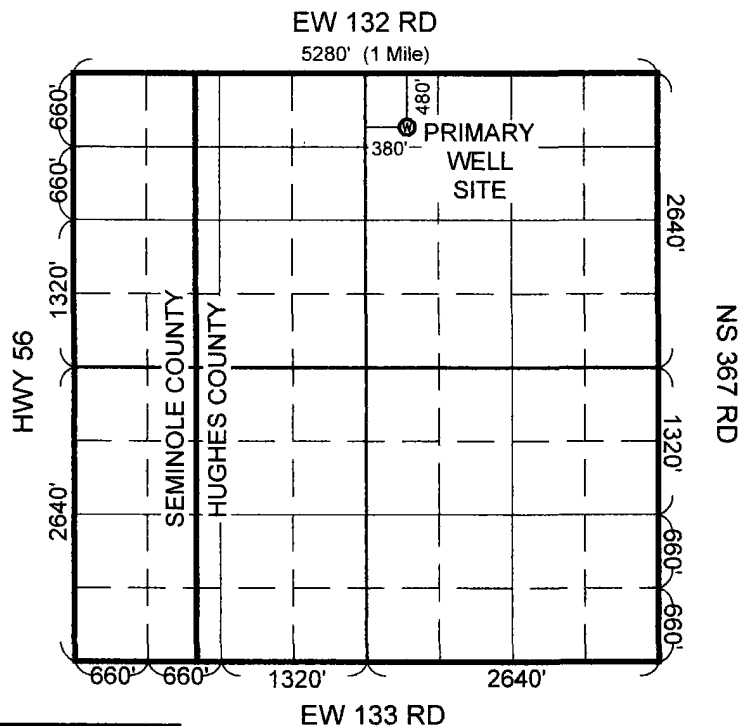

LINE AND SYMBOL LEGEND

 PROPOSED WELL LOCATION

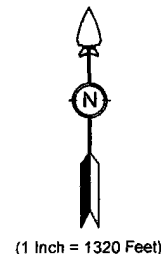

WELL DATA

WELL DESC.	DISTANCE FNL	DISTANCE FWL	LAT. (DMS)	LONG (DMS)	LAT (DEC.)	LONG (DEC.)	GROUND ELEV.
PRIMARY	480' FNL	380' FWL	35° 06' 00.16" N	96° 29' 03.19" W	35.10004	-96.48422	944.3'

NOTES

- 1.) This Well Survey Exhibit was prepared for Rayland Operating and authorized by Doug Worley on March 21, 2018.
- 2.) While the locations as shown hereon were carefully staked and/or located according to official survey records, plats or other maps, it is not a land or boundary survey plat. Any linear and angular values shown on the sketch, if any, are based on record or deed information and have not been verified unless noted.
- 3.) Vertical Datum: NAVD 1929



FORESIGHT LAND SURVEYING, LLC
 1109 WARREN ROAD
 HENRYETTA, OK 74437
 918-268-2502
 OFFICE@FORESIGHTSURVEYING.NET
 WWW.FORESIGHTSURVEYING.NET
 CA #7652

SHEET: 1 OF 1
 Date: 04/12/2018
 Drawn by: JRL
 Fieldwork by: JDK
 For: D. Worley
 Rayland Operating
 Project No. 18-0131