

OKLAHOMA CORPORATION COMMISSION
OIL & GAS CONSERVATION DIVISION
P.O. BOX 52000
OKLAHOMA CITY, OK 73152-2000
(Rule 165:10-3-1)

API NUMBER: 087 22167

Approval Date: 07/26/2018

Expiration Date: 01/26/2019

Horizontal Hole Oil & Gas

PERMIT TO DRILL

WELL LOCATION: Sec: 07 Twp: 6N Rge: 3W County: MCCLAIN

SPOT LOCATION: ☐ SW ☐ SW ☐ SW ☐ SW FEET FROM QUARTER: FROM SOUTH FROM WEST

SECTION LINES: 215 240

Lease Name: LIGHTHORSE 18-19-0603

Well No: 1WXH

Well will be 215 feet from nearest unit or lease boundary.

Operator Name: NATIVE EXPLORATION OPERATING LLC

Telephone: 4058210568

OTC/OCC Number: 24070 0

NATIVE EXPLORATION OPERATING LLC
PO BOX 18108
OKLAHOMA CITY, OK 73154-0108

THOMAS D. & BETTY JOE RAPER
2650 48TH AVE. NW
NORMAN OK 73072

Formation(s) (Permit Valid for Listed Formations Only):

Name	Depth	Name	Depth
1 WOODFORD	9773	6	
2		7	
3		8	
4		9	
5		10	

Spacing Orders: 675972

Location Exception Orders:

Increased Density Orders:

Pending CD Numbers: 201804373
201804377
201804374

Special Orders:

Total Depth: 20600

Ground Elevation: 1155

Surface Casing: 1500

Depth to base of Treatable Water-Bearing FM: 150

Under Federal Jurisdiction: No

Fresh Water Supply Well Drilled: No

Surface Water used to Drill: Yes

PIT 1 INFORMATION

Approved Method for disposal of Drilling Fluids:

Type of Pit System: CLOSED Closed System Means Steel Pits

Type of Mud System: WATER BASED

Chlorides Max: 5000 Average: 3000

Is depth to top of ground water greater than 10ft below base of pit? Y

Within 1 mile of municipal water well? N

Wellhead Protection Area? N

Pit is located in a Hydrologically Sensitive Area.

Category of Pit: C

Liner not required for Category: C

Pit Location is BED AQUIFER

Pit Location Formation: DUNCAN

D. One time land application -- (REQUIRES PERMIT)

PERMIT NO: 18-35018

H. SEE MEMO

This permit does not address the right of entry or settlement of surface damages.

The duration of this permit is SIX MONTHS, except as otherwise provided by Rule 165: 10-3-1.

Rule 165: 10-3-4 (c) (7) (e) - The Operator shall give 24 Hours notice by telephone to the appropriate District Office of the Conservation Division as to when Surface Casing will be run.

PIT 2 INFORMATION

Type of Pit System: CLOSED Closed System Means Steel Pits

Type of Mud System: OIL BASED

Chlorides Max: 300000 Average: 200000

Is depth to top of ground water greater than 10ft below base of pit? Y

Within 1 mile of municipal water well? N

Wellhead Protection Area? N

Pit is located in a Hydrologically Sensitive Area.

Category of Pit: C

Liner not required for Category: C

Pit Location is BED AQUIFER

Pit Location Formation: DUNCAN

HORIZONTAL HOLE 1

Sec 19 Twp 6N Rge 3W County MCCLAIN

Spot Location of End Point: S2 SW SW SW

Feet From: SOUTH 1/4 Section Line: 50

Feet From: WEST 1/4 Section Line: 330

Depth of Deviation: 9317

Radius of Turn: 573

Direction: 179

Total Length: 10383

Measured Total Depth: 20600

True Vertical Depth: 9843

End Point Location from Lease,
Unit, or Property Line: 50

Notes:

Category

Description

DEEP SURFACE CASING

7/26/2018 - G71 - APPROVED; NOTIFY OCC FIELD INSPECTOR IMMEDIATELY FOR ANY LOSS OF CIRCULATION OR FAILURE TO CIRCULATE CEMENT TO SURFACE ON CONDUCTOR OR SURFACE CASING

HYDRAULIC FRACTURING

7/26/2018 - G71 - OCC 165:10-3-10 REQUIRES:

1) PRIOR TO COMMENCEMENT OF HYDRAULIC FRACTURING OPERATIONS FOR HORIZONTAL WELLS, NOTICE GIVEN FIVE BUSINESS DAYS IN ADVANCE TO OFFSET OPERATORS WITH WELLS COMPLETED IN THE SAME COMMON SOURCE OF SUPPLY WITHIN 1/2 MILE;

2) WITH NOTICE ALSO GIVEN 48 HOURS IN ADVANCE OF HYDRAULIC FRACTURING ALL WELLS TO BOTH THE OCC CENTRAL OFFICE AND LOCAL DISTRICT OFFICES, USING THE "FRAC NOTICE FORM" FOUND AT THE FOLLOWING LINK: OCCEWEB.COM/OG/OGFORMS.HTML; AND,

3) THE CHEMICAL DISCLOSURE OF HYDRAULIC FRACTURING INGREDIENTS FOR ALL WELLS TO BE REPORTED TO FRACFOCUS WITHIN 60 DAYS AFTER THE CONCLUSION THE HYDRAULIC FRACTURING OPERATIONS, USING THE FOLLOWING LINK: FRACFOCUS.ORG

MEMO

7/26/2018 - G71 - PIT 1 & 2 - CLOSED SYSTEM=STEEL PITS PER OPERATOR REQUEST; PIT 2 - OBM TO VENDOR, OBM CUTTINGS PER DISTRICT

PENDING CD - 201804373

7/26/2018 - G75 - (E.O.)(640)(HOR) 18-6N-3W
VAC OTHER
EXT 675972 WDFD, OTHERS
POE TO BHL NCT 165' FNL & FSL, NCT 330' FEL & FWL
NATIVE EXPLOR. OP., LLC
REC 7-25-2018 (MINMIER)

This permit does not address the right of entry or settlement of surface damages.

The duration of this permit is SIX MONTHS, except as otherwise provided by Rule 165: 10-3-1.

Rule 165: 10-3-4 (c) (7) (e) - The Operator shall give 24 Hours notice by telephone to the appropriate District Office of the Conservation Division as to when Surface Casing will be run.

087 22167 LIGHTHORSE 18-19-0603 1WXH

Category	Description
PENDING CD - 201804374	<p>7/26/2018 - G75 - (E.O.) 18 & 19-6N-3W EST MULTIUNIT HORIZONTAL WELL X201804373 WDFD, OTHERS 18-6N-3W X675972 WDFD, OTHERS 19-6N-3W 33% 18-6N-3W ** 67% 19-6N-3W ** NATIVE EXPLOR. OP., LLC REC 7-25-2018 (MINMIER)</p> <p>** S/B 50% 18-6N-3W & 50% 19-6N-3W; TO BE CORRECTED AT MERIT HEARING ON 8-6-2018 PER ATTORNEY FOR OPERATOR</p>
PENDING CD - 201804377	<p>7/26/2018 - G75 - (E.O.) 18 & 19-6N-3W X201804373 WDFD, OTHERS 18-6N-3W X675972 WDFD, OTHERS 19-6N-3W COMPL. INT. (18-6N-3W) NCT 150' FNL, NCT 0' FSL, NCT 330' FWL COMPL. INT. (19-6N-3W) NCT 0' FNL, NCT 150' FSL, NCT 330' FWL NATIVE EXPLOR. OP., LLC REC 7-25-2018 (MINMIER)</p>
SPACING - 675972	<p>7/26/2018 - G75 - (640)(HOR) 19-6N-3W VAC OTHERS EXT 637464 WDFD, OTHERS POE TO BHL NCT 165' FNL & FSL, NCT 330' FEL & FWL</p>

NOTE:
The information shown herein is for
construction purposes ONLY.

TOPOGRAPHIC LAND SURVEYORS OF OKLAHOMA

13800 Wireless Way, Okla. City, OK 73134 (405) 843-4447 • OUT OF STATE (800) 654-3219

MOCLAIN Certificate of Authorization No. 1293 LS

215 FSL - 240 FWL Section 7 Township 6N County, Oklahoma

Range 3W I.M.

LANDING POINT, BOTTOM HOLE AND DRILL PATH INFORMATION
PROVIDED BY OPERATOR LISTED, NOT SURVEYED.

API 087-22167

X 2135625
Y 609682

X 2135644
Y 607036

X 2133004
Y 607023

X 2135657
Y 604392

X 2135670
Y 601747

X 2133031
Y 601732

X 2135679
Y 599100

X 2135687
Y 596432

LANDING POINT
150' FNL - 330' FWL
NAD-27 (US Feet)
35°00'00.5" N
97°33'48.2" W
35.000138656" N
97.563394492" W
X=2130761
Y=606861

BOTTOM HOLE
50' FSL - 330' FWL
NAD-27 (US Feet)
34°58'17.8" N
97°33'48.4" W
34.971610936" N
97.563440944" W
X=2130792
Y=596478



GRID
NAD-27
OK SOUTH
US Feet

X 2133044
Y 596439

Lot 3

Lot 4

Lot 1

Lot 2

Lot 3

Lot 4

Lot 1

Lot 2

Lot 3

Lot 4

2430'

240'

215'

LANDING POINT

PROPOSED DRILL PATH

ELEVATION:
1155' Gr. at Stake

Range Line P T6N - R3W
T6N - R4W

X 2130446
Y 601718

X 2130454
Y 598072

X 2130462
Y 596427

Operator: NATIVE EXPLORATION OPERATING, LLC

Lease Name: LIGHTHORSE 18-19-0603

Well No.: 1WYH

Topography & Vegetation Loc. fell in rolling pasture with scattered brush

Good Drill Site? Yes Reference Stakes or Alternate Location Stakes Set None

Best Accessibility to Location From West off St. Hwy. 59

Distance & Direction from Hwy Jct or Town The Jct. of St. Hwy. 36 and St. Hwy. 59 is at

the NW Cor. of Sec. 7-T6N-R3W

Date of Drawing: Jul. 16, 2018

Invoice # 297939A Date Staked: Jul. 06, 2018

AC

CERTIFICATE:

I, Thomas L. Howell, on Oklahoma
Licensed Land Surveyor and an authorized agent
of Topographic Land Surveyors of Oklahoma, do
hereby certify to the information shown herein.

Oklahoma Lic. No. 1433

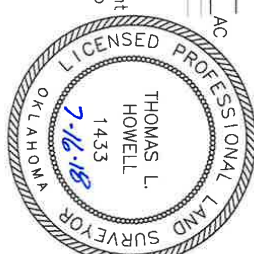

(This information was gathered with a GPS receiver with ±1 foot Horiz./Vert. accuracy.)