

OKLAHOMA CORPORATION COMMISSION
OIL & GAS CONSERVATION DIVISION
P.O. BOX 52000
OKLAHOMA CITY, OK 73152-2000
(Rule 165:10-3-1)

API NUMBER: 125 23937

Approval Date: 07/27/2018

Expiration Date: 01/27/2019

Straight Hole

Oil & Gas

PERMIT TO DRILL

WELL LOCATION: Sec: 04 Twp: 8N Rge: 5E

County: POTTAWATOMIE

SPOT LOCATION:

FEET FROM QUARTER: FROM SOUTH FROM WEST

SECTION LINES: 330 410

Lease Name: WYATT

Well No: 1-4

Well will be 330 feet from nearest unit or lease boundary.

Operator Name: BRIDON ENERGY LLC

Telephone: 4056378195

OTC/OCC Number: 22845 0

BRIDON ENERGY LLC
PO BOX 498
MUSTANG, OK 73064-0498

WES WOMACK
NS 352 RD
SEMINOLE OK 74868

Formation(s) (Permit Valid for Listed Formations Only):

	Name	Depth		Name	Depth
1	WEWOKA	2400	6	HUNTON	4000
2	CALVIN	2800	7	VIOLA	4140
3	EARLSBORO	3500	8	SIMPSON DOLOMITE	4210
4	MAYES	3700	9	WILCOX	4240
5	WOODFORD	3810	10		

Spacing Orders: 356766

Location Exception Orders:

Increased Density Orders:

Pending CD Numbers:

Special Orders:

Total Depth: 4400

Ground Elevation: 897

Surface Casing: 1070

Depth to base of Treatable Water-Bearing FM: 1010

Under Federal Jurisdiction: No

Fresh Water Supply Well Drilled: No

Surface Water used to Drill: No

PIT 1 INFORMATION

Approved Method for disposal of Drilling Fluids:

Type of Pit System: CLOSED Closed System Means Steel Pits

Type of Mud System: WATER BASED

Chlorides Max: 8000 Average: 5000

Is depth to top of ground water greater than 10ft below base of pit? Y

Within 1 mile of municipal water well? N

Wellhead Protection Area? N

Pit is located in a Hydrologically Sensitive Area.

Category of Pit: C

Liner not required for Category: C

Pit Location is ALLUVIAL

Pit Location Formation: ALLUVIUM

H. CLOSED SYSTEM=STEEL PITS (REQUIRED - LITTLE RIVER)

E. Haul to Commercial pit facility: Sec. 19 Twn. 8N Rng. 5E Cnty. 125 Order No: 274874

Notes:

This permit does not address the right of entry or settlement of surface damages.
The duration of this permit is SIX MONTHS, except as otherwise provided by Rule 165: 10-3-1.
Rule 165: 10-3-4 (c) (7) (e) - The Operator shall give 24 Hours notice by telephone to the appropriate District Office of the Conservation Division as to when Surface Casing will be run.

125 23937 WYATT 1-4

Category	Description
HYDRAULIC FRACTURING	<p>7/13/2018 - G71 - OCC 165:10-3-10 REQUIRES:</p> <p>1) PRIOR TO COMMENCEMENT OF HYDRAULIC FRACTURING OPERATIONS FOR HORIZONTAL WELLS, NOTICE GIVEN FIVE BUSINESS DAYS IN ADVANCE TO OFFSET OPERATORS WITH WELLS COMPLETED IN THE SAME COMMON SOURCE OF SUPPLY WITHIN 1/2 MILE;</p> <p>2) WITH NOTICE ALSO GIVEN 48 HOURS IN ADVANCE OF HYDRAULIC FRACTURING ALL WELLS TO BOTH THE OCC CENTRAL OFFICE AND LOCAL DISTRICT OFFICES, USING THE "FRAC NOTICE FORM" FOUND AT THE FOLLOWING LINK: OCCWEB.COM/OG/OGFORMS.HTML; AND,</p> <p>3) THE CHEMICAL DISCLOSURE OF HYDRAULIC FRACTURING INGREDIENTS FOR ALL WELLS TO BE REPORTED TO FRACFOCUS WITHIN 60 DAYS AFTER THE CONCLUSION THE HYDRAULIC FRACTURING OPERATIONS, USING THE FOLLOWING LINK: FRACFOCUS.ORG</p>
SPACING	<p>7/27/2018 - G57 - FORMATIONS UNSPACED(ERLB, WDFD); LEASE OUTLINE 40-ACRES SW4 NE4 4-8N-5E PER OPERATOR</p>
SPACING - 356766	<p>7/27/2018 - G57 - (40) W2 NE4 4-8N-5E AMD 200154 TO 40-ACRES FOR WWK, CLVN, MYES, HNTN, VIOL, SMPSD, WLCX</p>

This permit does not address the right of entry or settlement of surface damages.

The duration of this permit is SIX MONTHS, except as otherwise provided by Rule 165: 10-3-1.

Rule 165: 10-3-4 (c) (7) (e) - The Operator shall give 24 Hours notice by telephone to the appropriate District Office of the Conservation Division as to when Surface Casing will be run.

125 23937 WYATT 1-4

KNIGHT LAND SURVEY

P.O. BOX 231, Shawnee, Oklahoma 74802 * LOCAL (405) 273-6223

Certificate of Authorization No. 3252, Exp. June 30, 2019

330 FSL & 910' FEL OF THE SW/4-NE/4

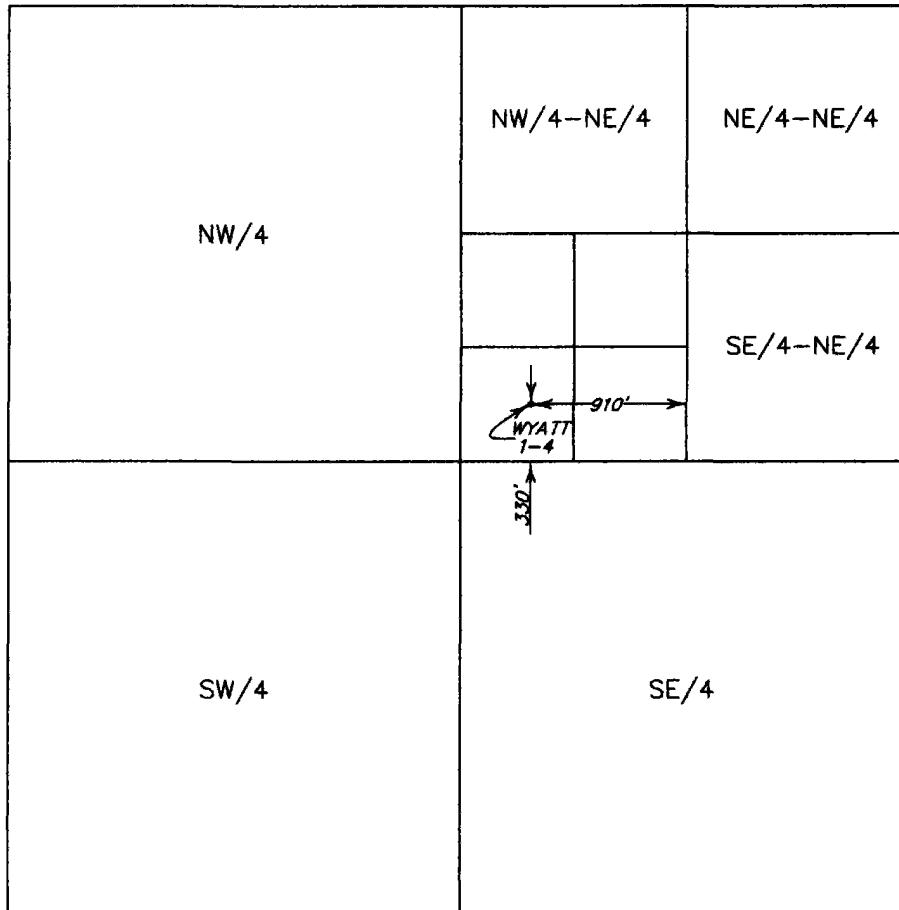
Section 4 - Township 8 North - Range 5 East - Indian Meridian
Pottawatomie County, Oklahoma

Scale: 1" = 1000'

Operator: BRIDON ENERGY, LLC
Lease Name: WYATT 1-4Well No.: WYATT 1-4

ELEVATION:

894' GR STAKETopography & Vegetation SCATTERED TIMBERGood Drill Site? YES Alternate Location: N/A

Distance & Direction from Hwy Jct or Town-INTERSECTION OF S.H. 9 & N-S 3510 RD. NEAR EARLSBORO, OK. GO 2.3 MILES SOUTH TO E-W 1240 RD., GO 1 MILE WEST TO N-S 3500 RD., GO SOUTH 1.3 MILES TO DEAD END ROAD WITH EXISTING HOUSE. WELL IS LOCATED 750 FEET SOUTH AND 950 FEET WEST OF HOUSE.

Job # JN 1590Date Staked: July 9, 2018

GPS

DATUM: WGS 84LAT: N 35°11'46.237"LONG: W -96°46'49.34294"

(Accuracy ±1-3 Meters.)

This location has been carefully staked on the ground according to the best official survey records, maps, and photographs available to us, but its accuracy is not guaranteed. For intent purposes only. Review this plat and notify us immediately of any possible discrepancy.

CERTIFICATE:

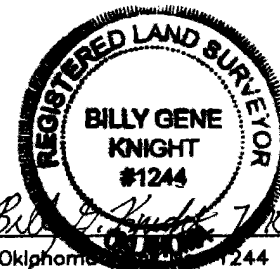
I, Billy Gene Knight a
Registered Land Surveyor for
Knight Land Survey do hereby
certify that the above described
well location was surveyed and
staked on the ground as
shown and described herein.

The signature and seal shown are in digital form, see official instruments for original seal and signature which are an identical representation of this document.

Oklahoma 1244